

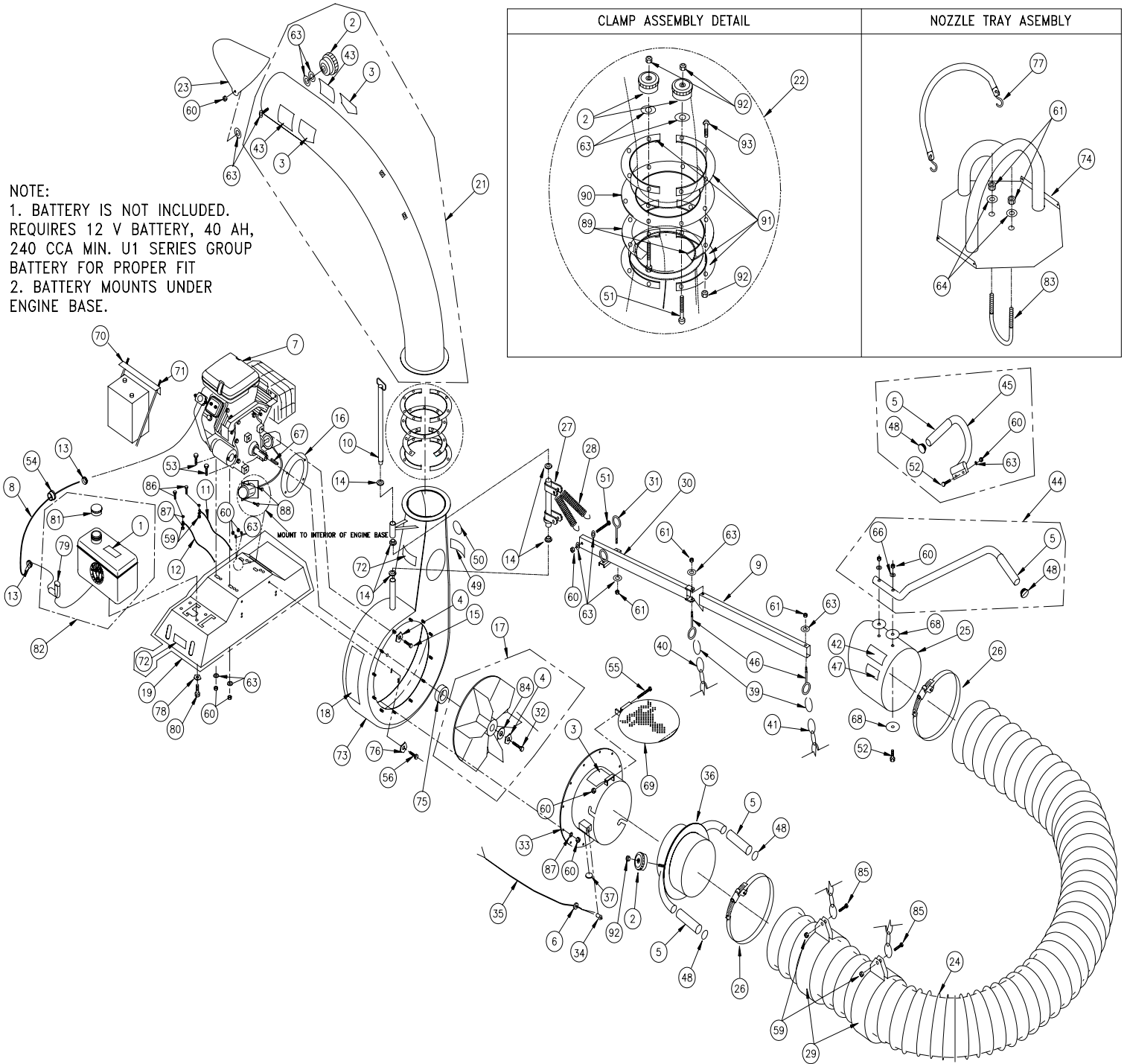

PARTS DRAWING QL2300KO

NOTE:
1. BATTERY IS NOT INCLUDED.
REQUIRES 12 V BATTERY, 40 AH,
240 CCA MIN. U1 SERIES GROUP
BATTERY FOR PROPER FIT
2. BATTERY MOUNTS UNDER
ENGINE BASE.





PARTS LIST

ITEM NO.	PART NO.	DESCRIPTION	QTY	ITEM NO.	PART NO.	DESCRIPTION	QTY
1	400268	LABEL HOT ENGINE	1	51	*8024044	BOLT CARRAIGE 5/16-18 x 2	2
2	400339	KNOB	4	52	*8041030	SCREWCAP 5/16-18 x 1 1/2	4
3	400424	LABEL OPEI WARNING	3	53	*8041031	SCREWCAP 5/16-18 x 1 3/4	4
4	850132	WASHER TWISTED LOCK 7/16"	5	54	790310	GROMNET 1" x 3/4" I.D.	4
5	500267	GRIP HANDLE	4	55	*8024050	BOLT CARR. 5/16 - 18 x 3 1/2	1
6	500282	STRAIN RELIEF HEYCO 1244	1	56	*8041051	SCREW CAP 3/8 - 16x 1 1/4	4
7	790275	ENGINE 23 HP HORIZ. KOHLER COMMAND PRO	1	57			
8	790129	LINE FUEL QL	1	58	*8122082	SCREW SM 1/4 x 3/4	5
9	790263	TUBE BOOM ARM QL	1	59	*8160001	NUT LOCK 1/4"-20 HEX Z/P	8
10	790271	PIN 5/8 X 15.5 QL	1	60	*8160002	NUT LOCK 5/16-18	21
11	790132	CABLE BATTERY RED 26"	1	61	*8160003	NUT LOCK 3/8	10
12	790133	CABLE BATTERY BLACK 10"	1	62			
13	790134	CLAMP FUEL LINE	2	63	*8171003	WASHER 5/16 FLAT CUT	22
14	510185	BUSHING NYLON 0.625	5	64	*8171004	WASHER FLAT 3/8	10
15	790307	SCREWCAP 7/16-14 x 2" GR. 5	4	65	*8172007	WASHER 1/4 SAE	6
16	790293	PLATE RING SPACER QL KOHLER	1	66	*8172008	WASHER 5/16 SAE	2
17	790103-S	IMPELLER 16" x 1.12" ASSY QL (INCL. 4,32,84)	1	67	*9201125	KEY 1/4 x 2 3/4	1
18	790142	LABEL QL INSTRUCT/WARN	1	68	*8172020	WASHER 5/16 FENDER	4
19	790143-S	BASE ENGINE ASSY QL(INCLUDES 72)	1	69	790298	DOOR FLAPPER INTAKE QL23	1
20				70	790230	BRACKET BATTERY QL	1
21	790145-S	ELBOW 8" ASSY QL(INCLUDES 2,3,43)	1	71	790231	ROD BATTERY HOLD DOWN	2
22	790255-S	CLAMP ASSEMBLY	1	72	790232	LABEL WARNING SECURE	3
23	790147	DEFLECTOR EXHAUST QL	1	73	790105	HOUSING ASSY QL	1
24	791034	HOSE 12" x 10'	1	74	790285	TRAY NOZZLE WA QL23KO	2
25	790149	NOZZLE INTAKE 12" FORMED	1	75	790311	SPACER - ENGINE	1
26	790150	CLAMP HOSE 12"	2	76	400502	WASHER LOCK TWISTED TOOTH	4
27	790270	BOOM HINGE WA QL	1	77	790303	BUNGEE CORD BLACK 14"	1
28	790152	SPRING BOOM QL	2	78	8177011	WASHER LOCK TWISTED TOOTH	4
29	790153	BAND HOSE BOOM 12" FORMED	2	79	790240	90 DEGREE ELBOW 1/8" NPT MALE X 1/4"	1
30	790267	ARM BOOM WA QL	1	80	*8041026	SCREWCAP 5/16-18 X 3/4 HCS ZP	4
31	790291	BOLT EYE 3/8" x 2.5"	2	81	790258	CAP TANK FUEL 3 GAL	1
32	500188	SCREWCAP 7/16-20X2" GR.8 [TORQUE 60 ft.lb. (81.4Nm)]	1	82	790259	TANK FUEL 3 GAL ASSY	1
33	790288	INTAKE HOUSING ASSY (INCL. 3,6,34,35,37,55,60,63,69)	1	83	790204	U-BOLT 3/8" -16 - X 3	1
34	890440	PLUNGE SWITCH	1	84	850443	WASHER PLATE IMPELLER	1
35	790305	HARNESS WIRE ASSY QL23 KO	1	85	8041008	SCREWCAP 1/4-20 x 1 1/2	1
36	790289	HOSE INTAKE ASSY QL (INCL. 2,38,48,92)	1	86	8041004	SCREWCAP 1/4-20 X 3/4" HCS ZP	2
37	811123	PLUG 3/4"	1	87	8171002	WASHER 1/4	14
38				88	8024040	CARRIAGE BOLT 5/16x18x1	2
39	811160	LINKGAGE 1/4" CHAIN	2	89	790254	PLATE CLAMP SPLIT	2
40	790306	CHAIN 5 LINKS	1	90	790253	PLATE CLAMP SPACER	1
41	790189	CHAIN HANG HOSE QL	1	91	790252	PLATE CLAMP HALF	4
42	790301	LABEL WARNING NOZZLE	1	92	8161041	LOCK NUT 5/16-18 THIN ZP	11
43	810736	LABEL FLYING DEBRIS	2	93	8024040	BOLT CARRIAGE 5/16-1" ZP	6
44	811020	HANDLE NOZZLE W/ GRIP	1				
45	811019	HANDLE ADJ. NOZZLE W/ GRIP	1				
46	790290	BOLT EYE 3/8" X 5"	2				
47	811215	LABEL SECURE NOZZLE	1				
48	890132	PLUG RD 1"	4				
49	890254	LABEL EAR EYE BREATHE	1				
50	890301	LABEL READ	1				